

CVB

extension

resear

CVB P^{no} Vi

V_n

P

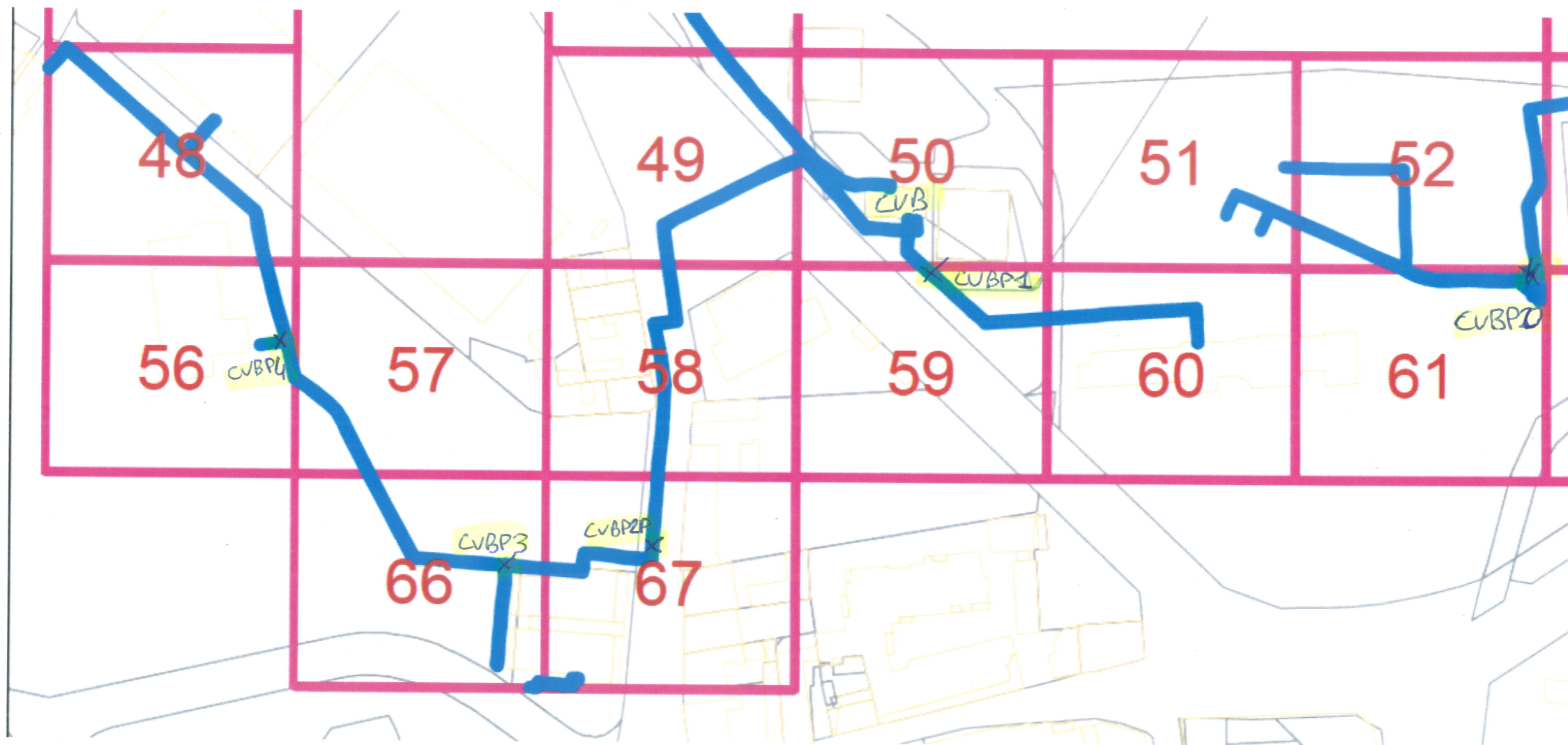

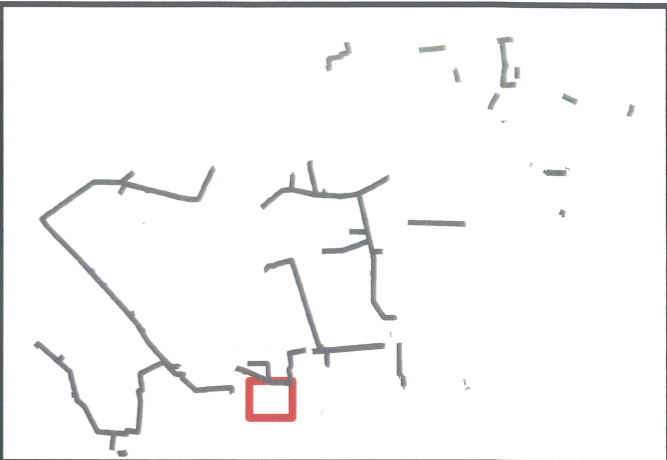
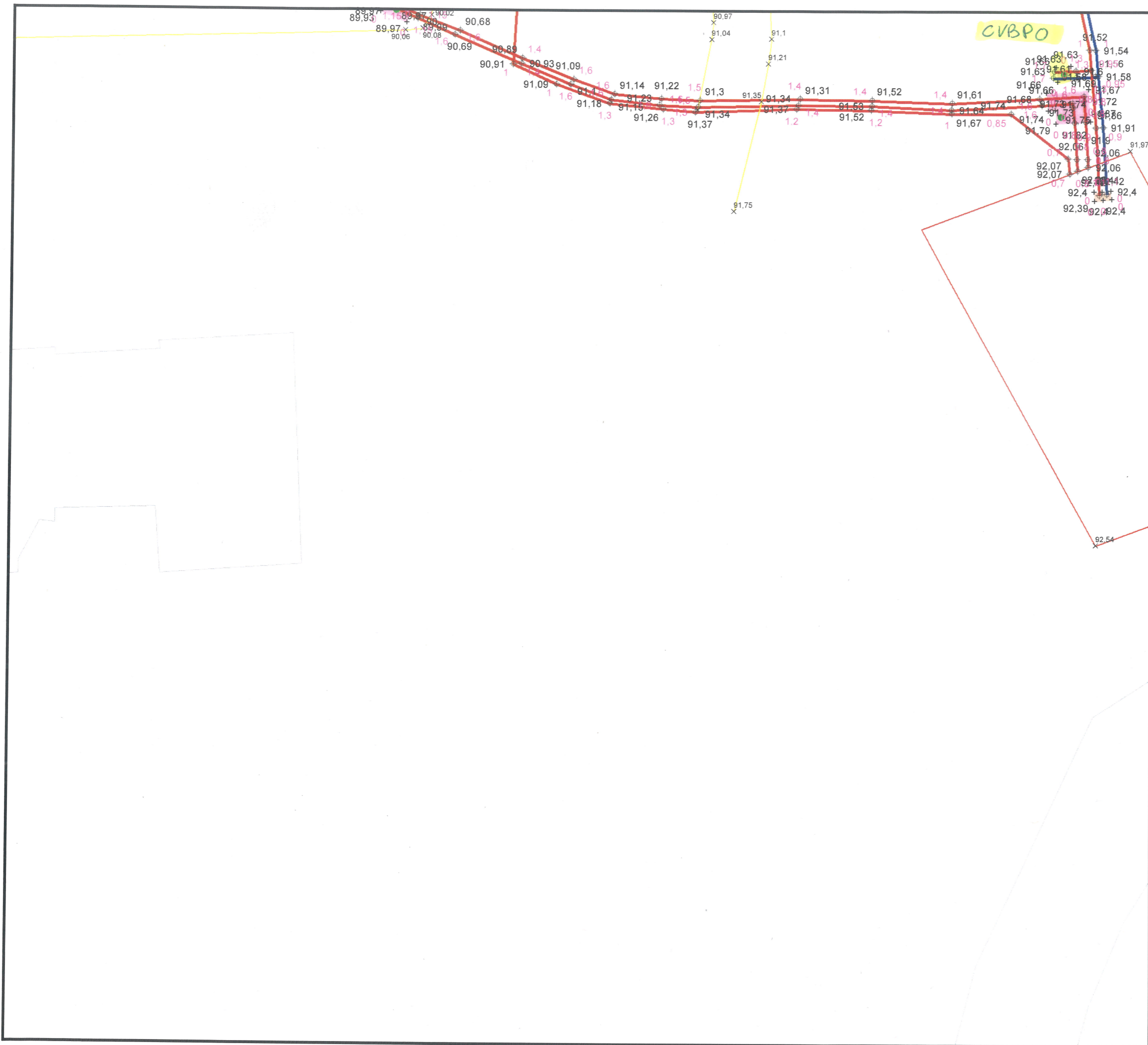

Legend

SYMB_TOPO

- × Point topographique

TOPOG_RES

- + Emprise chambre
- ⊕ Tube réseau

SYMB_RES

- Tampon

FOND_PLAN

- FOND_PLAN

LIN_TOPO

- Bordure trottoir
- Bâtiment

TUBE_RES

- aller
- retour

POLY_RES

- Chambre de Vannes
- Tampon de visite

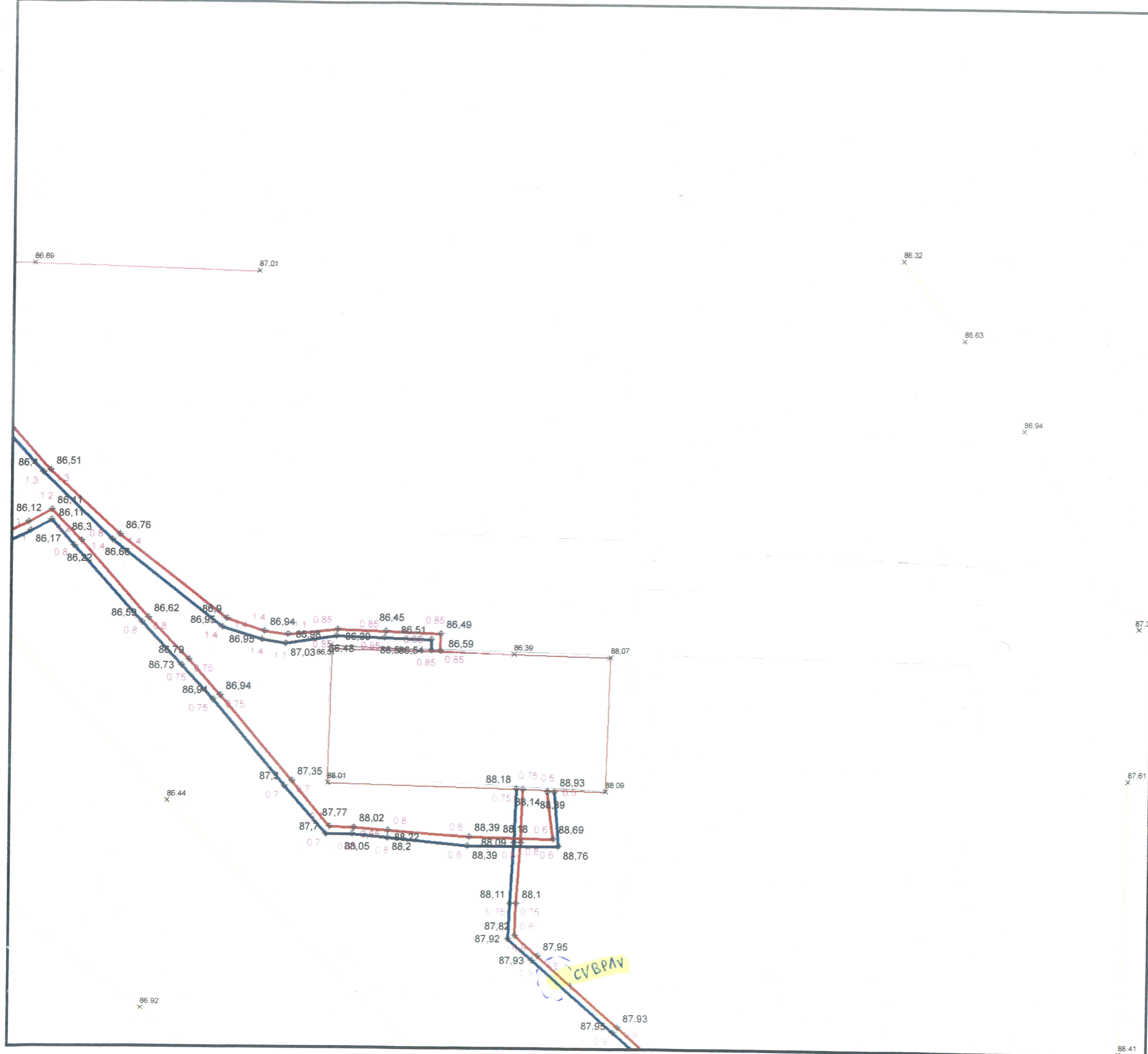
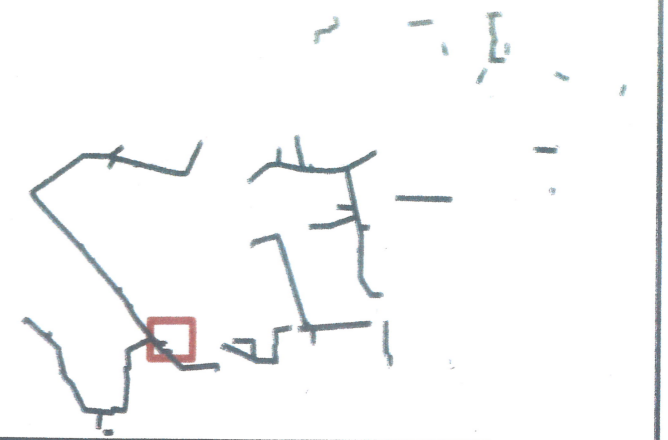

Legend

SYMB_TOPO

x Point topographique

TOPOG_RES

⊕ Tube réseau

FOND_PLAN

— FOND_PLAN

LIN_TOPO

— Bordure trottoir

— Bâtiment

— Façade

TUBE_RES

— aller

— retour

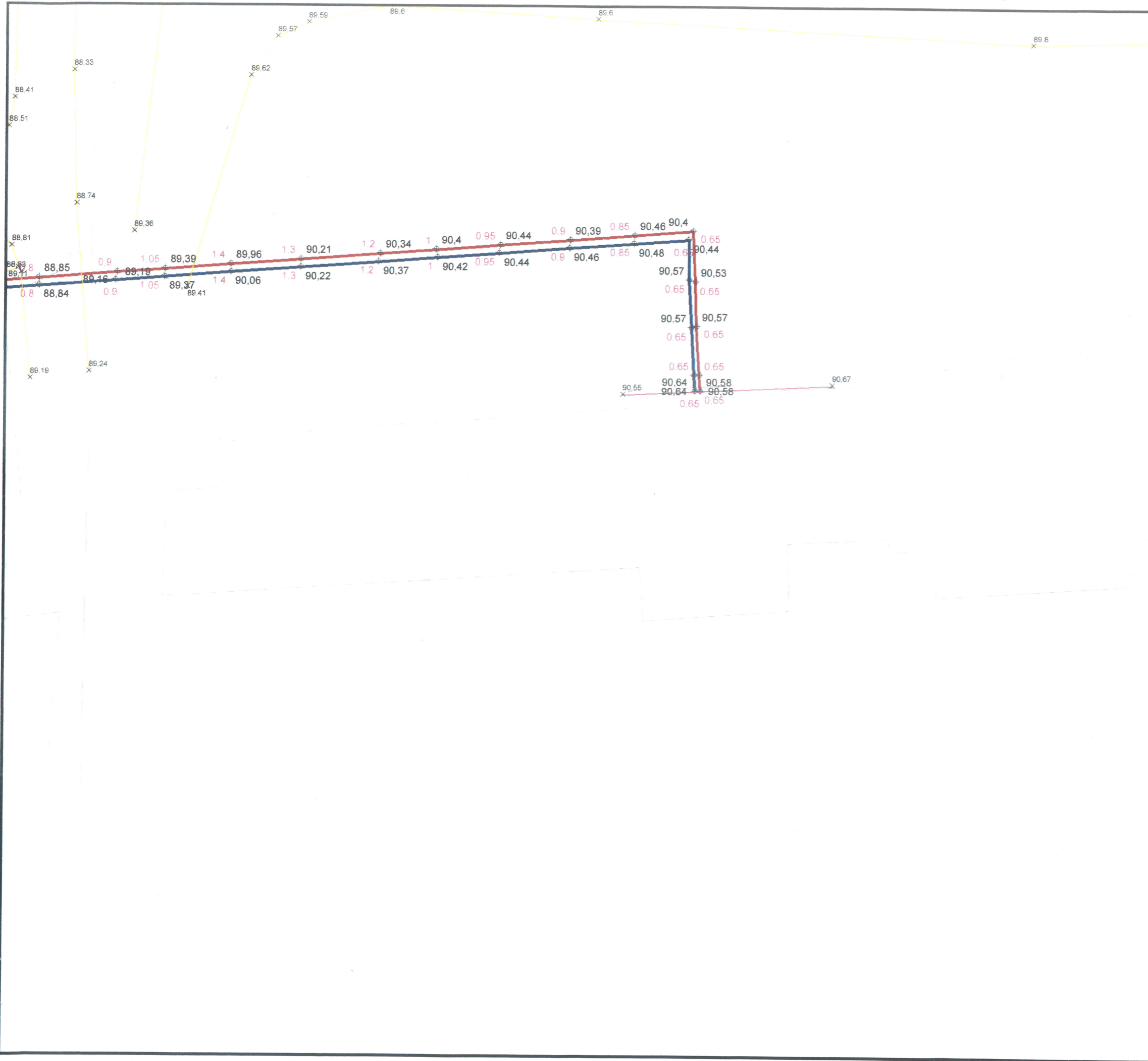

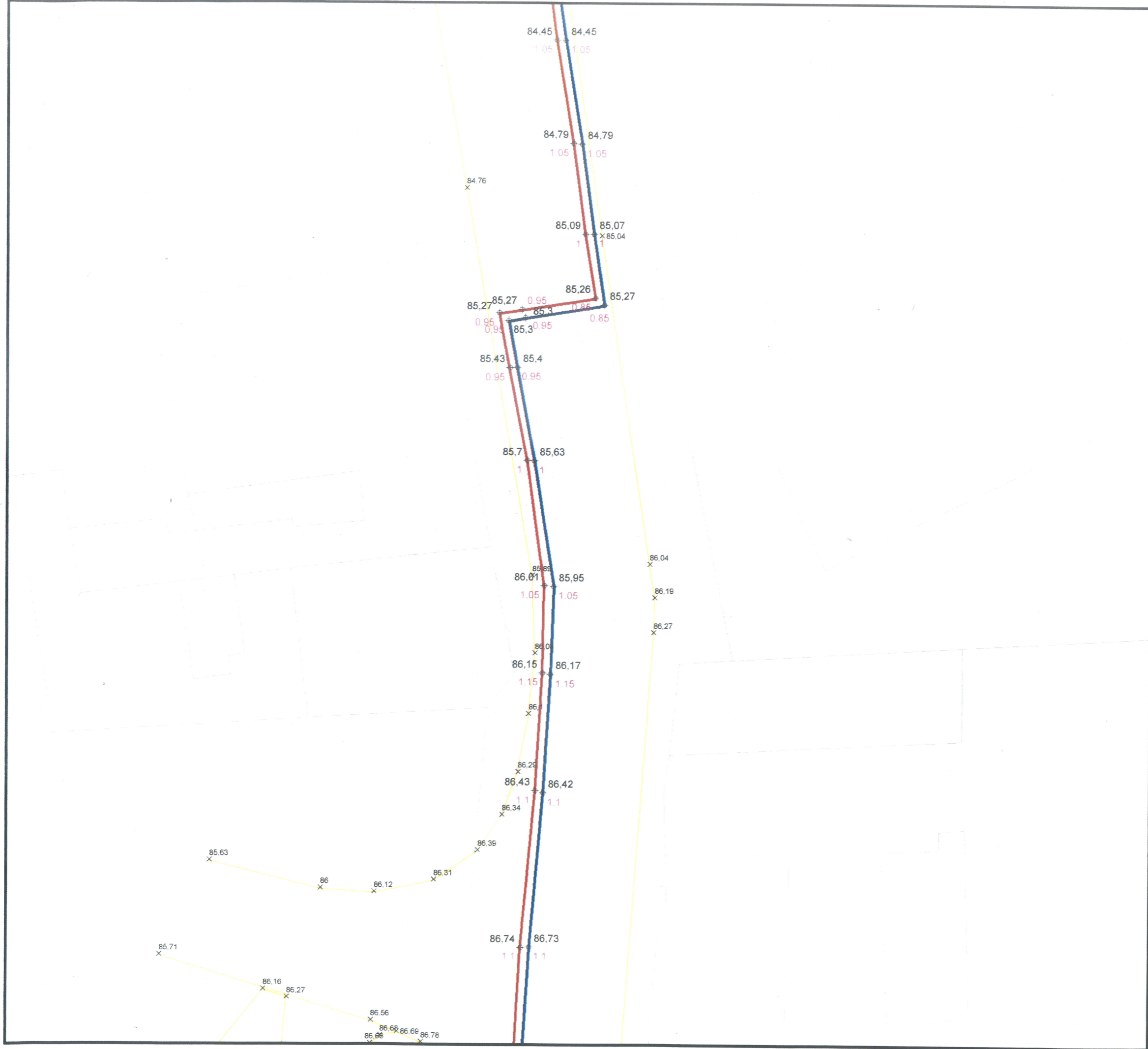

Legend

SYMB_TOPO

× Point topographique

TOPOG_RES

⊕ Tube réseau

FOND_PLAN

— FOND_PLAN

LIN_TOPO

— Bordure trottoir

TUBE_RES

— aller

— retour

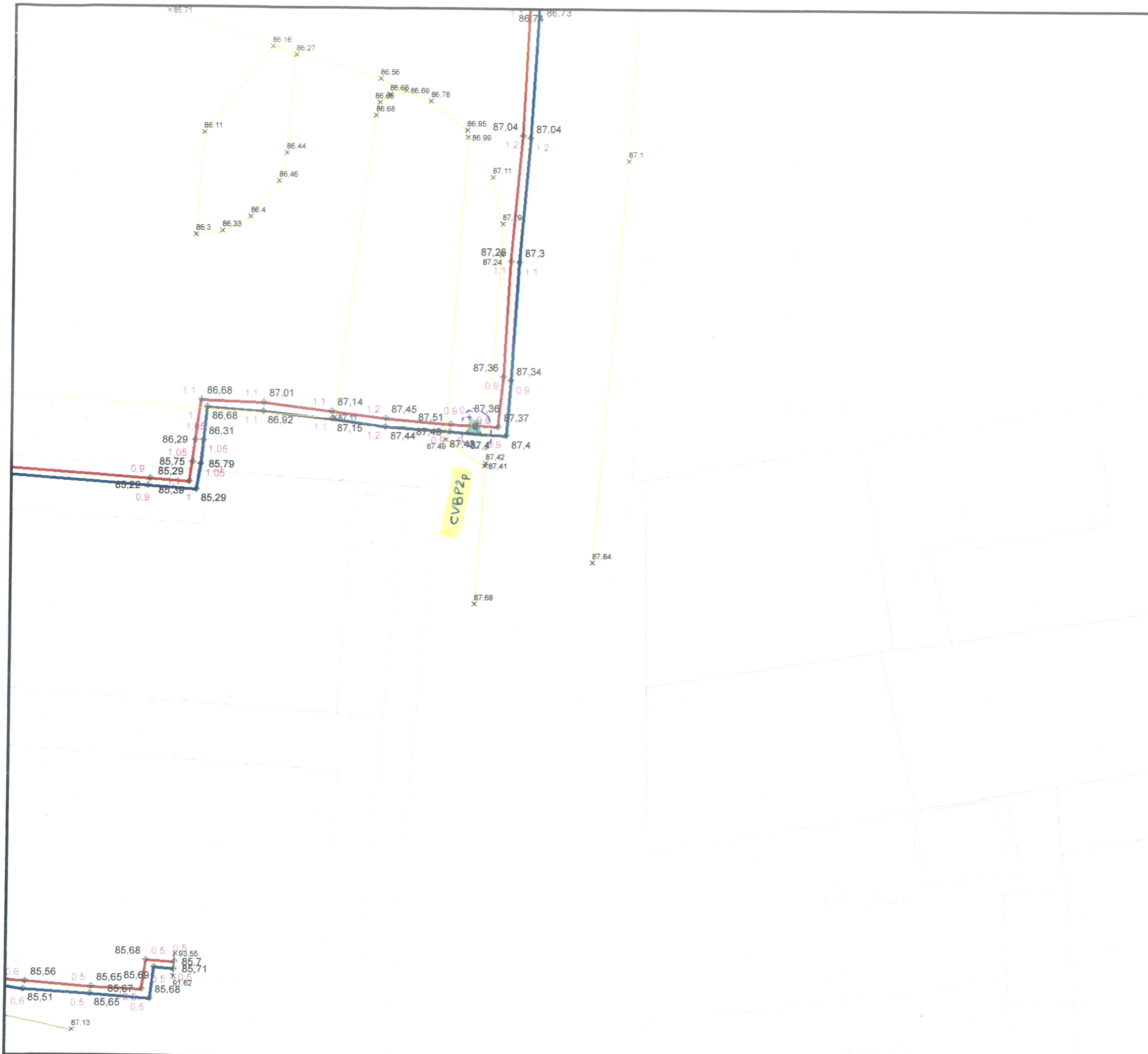

Legend

SYMB_TOPO

- × Point topographique

TOPOG_RES

- + Emprise chambre
- ⊕ Tube réseau

SYMB_RES

- Purge
- Tampon

FOND_PLAN

- FOND_PLAN

LIN_TOPO

- Bordure trottoir
- Cloture
- Façade

TUBE_RES

- aller
- retour

POLY_RES

- Chambre de Purge

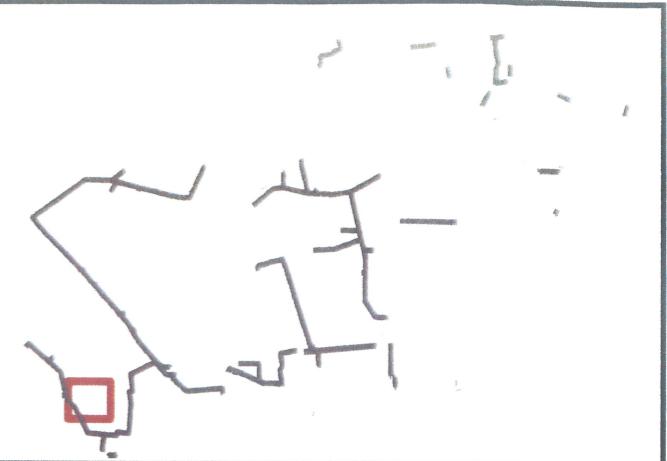
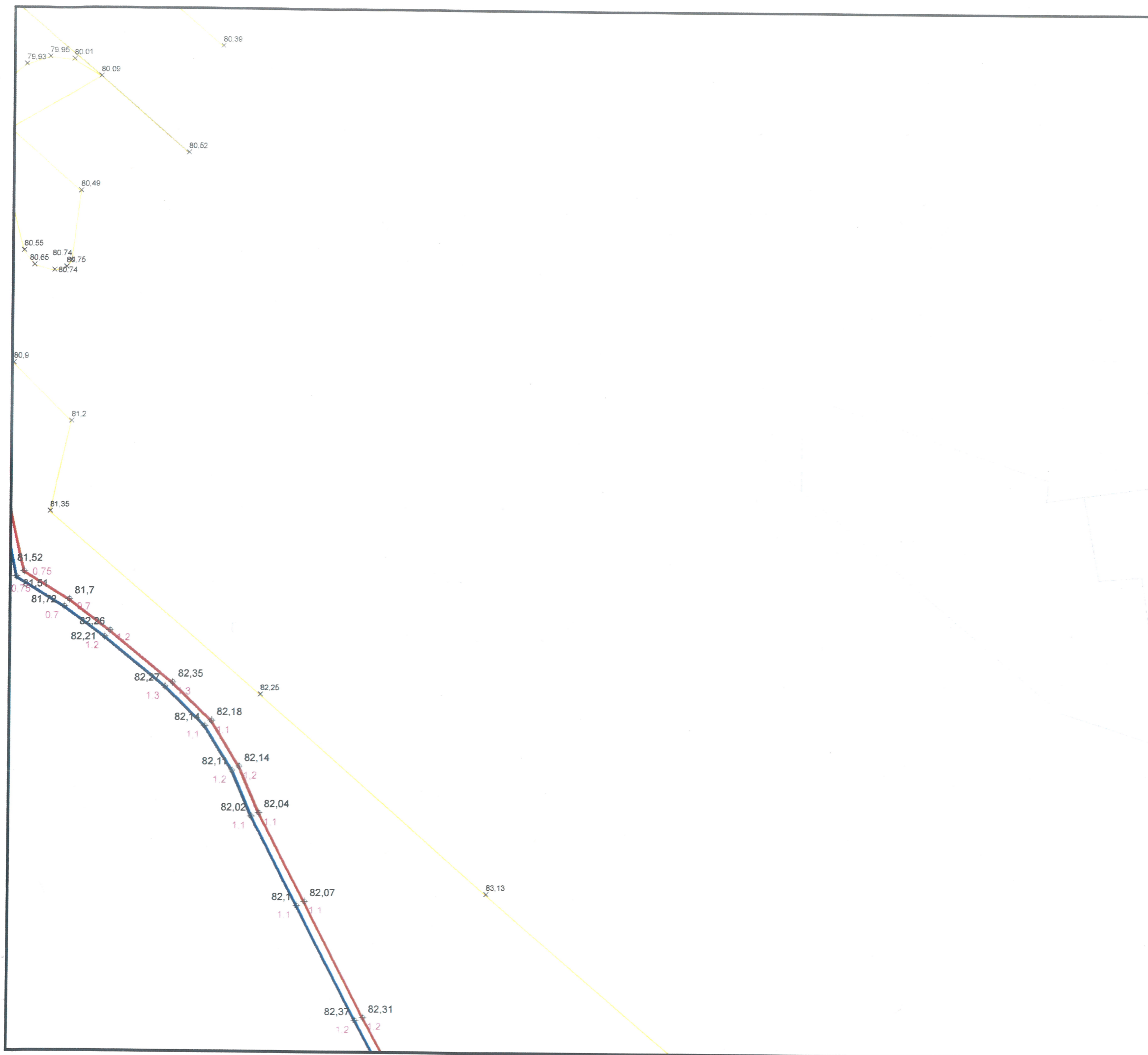

Legend

SYMB_TOPO

× Point topographique

TOPOG_RES

⊕ Tube réseau

FOND_PLAN

— FOND_PLAN

LIN_TOPO

— Bordure trottoir

— Cloture

TUBE_RES

— aller

— retour

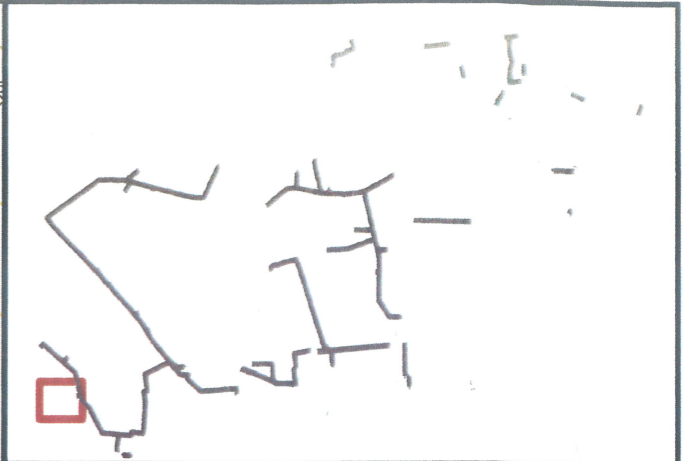

N
1:210

Legend

SYMB_TOPO

× Point topographique

TOPOG_RES

+ Emprise chambre

⊕ Tube réseau

SYMB_RES

⊗ Vannes

FOND_PLAN

— FOND_PLAN

LIN_TOPO

— Bordure trottoir

— Cloture

— Façade

TUBE_RES

— aller

— retour

POLY_RES

■ Chambre

■ Chambre de Vannes

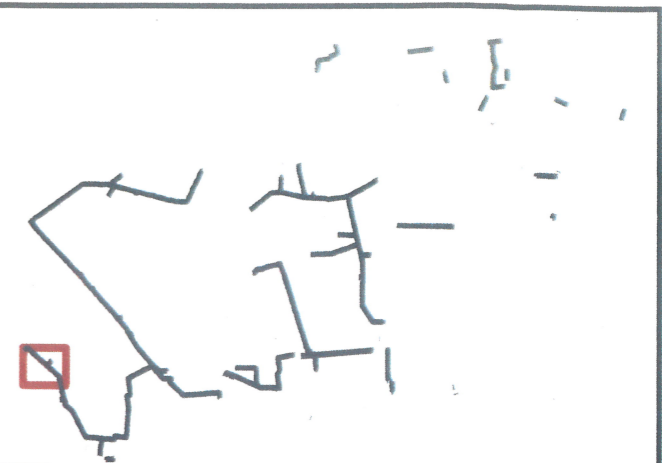
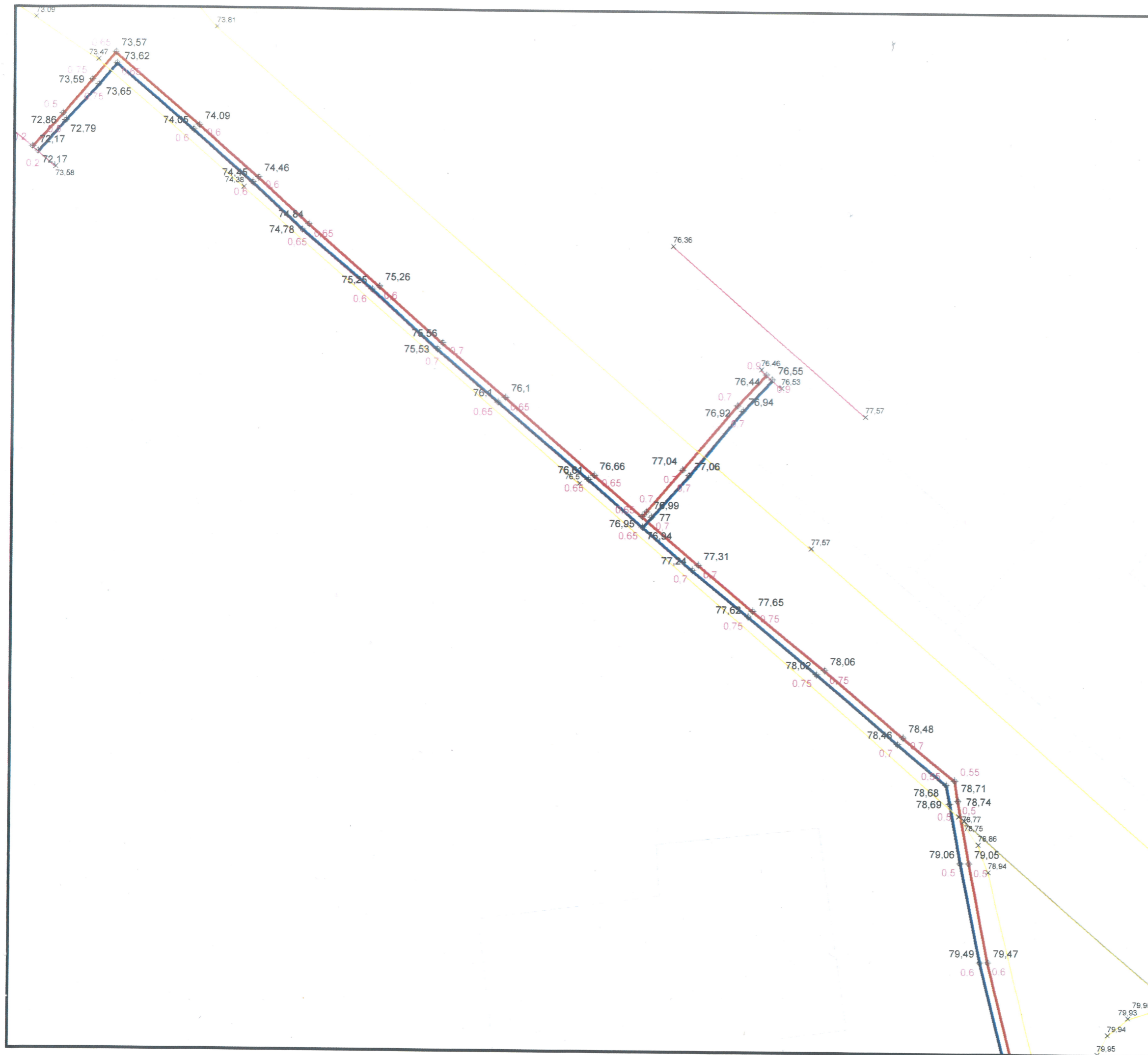

N
1:210

Legend

SYMB_TOPO

× Point topographique

TOPOG_RES

⊕ Tube réseau

FOND_PLAN

— FOND_PLAN

LIN_TOPO

— Bordure trottoir

— Cloture

— Façade

TUBE_RES

— aller

— retour



Legend

SYMB_TOPO

× Point topographique

TOPOG_RES

⊕ Tube réseau

FOND_PLAN

— FOND_PLAN

LIN_TOPO

— Bordure trottoir

TUBE_RES

— aller

— retour

